

Holsworthy High School

Parent Portal Registration

Welcome

Welcome to the new Sentral Parent Portal.

Staying in touch with your child's learning journey is easy with the Sentral Parent Portal.

Receive secure news items targeted for your child's school involvement on your mobile, tablet or computer.

The Sentral Parent Portal lets you:

- Stay informed with your targeted news feed
- Receive messages from your child's teachers
- See what homework your child has due
- Browse school documents and resources
- Receive your child's report cards electronically
- Book and manage parent/teacher night interviews
- Provide permission and make payments for school activities
- Pay your child's school fees
- Be notified of absence, respond to unexplained absences or advise the school in advance of planned absences

Portal is a useful resource for staying in touch with your child's school.

How To Register:

- Access Holsworthy High School's website:
<https://holsworthy-h.schools.nsw.gov.au/> or type school name in any web search engine.

The screenshot shows the Holsworthy High School website. At the top is the school logo and name. Below it is a navigation bar with links: 'About our school', 'Supporting our students', 'Learning at our school', 'Notes and Forms', 'Sentral Parent Portal' (highlighted with a red circle), and 'Contact us'. Below the navigation bar is a 'Quick Links' section with a link to 'Sentral Parent Portal'. At the bottom, there is a 'Parent Portal Registration' section with a link to 'Registration'.

➤ **Select Portal Tab**

➤ **Access Quick Links**

➤ **Complete Registration**

Note: You will need to have a valid email address to complete portal registration.

Sentral Parent Portal App

Sentral for Parents

The Sentral Parent app has been designed for parents to be more informed and in control of information. This app makes it very easy to monitor and manage all aspects of your child's education and interaction with the school.

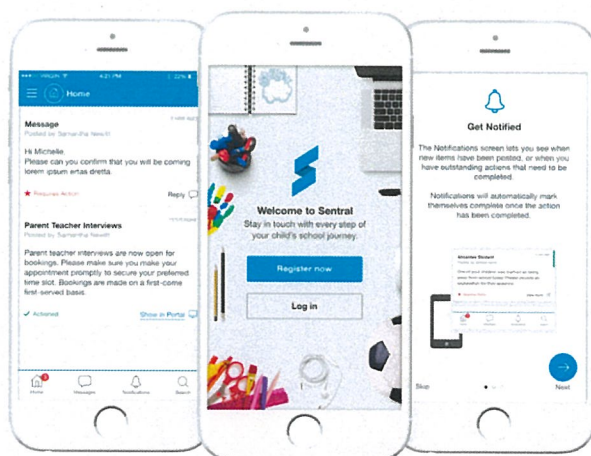

Sentral for Parents features



Better Informed

Receive push notifications about everything that's important for your child.



Information at your fingertips

Information that's most relevant and needs your attention appears clearly on your mobile device.



Communicate easily

With our instant messaging feature, have conversations with the school staff and get the feedback you want.



Instant payments

Pay for excursions, school fees and so much more. Right away with your credit card and record / track your bills.



Track homework

Know exactly what your child needs to complete at home.



Permit instantly

No more notices to sign or papers given to your child for carrying back. Approve instantly on your parent app.

Be part of your child's learning journey. Start today by registering and downloading the parent portal app.

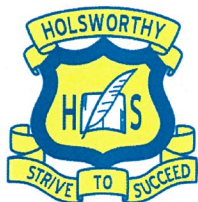

Holsworthy High School

Strive to Succeed and Be the Best You Can Be.

T: [02 9825 2888](tel:0298252888)

E: holsworthy-h.school@det.nsw.edu.au

Registration process:

Step 1: Registration

Visit the school's website and click on the Sentral Parent Portal tab to begin registration.

You must use a **valid email address to create your username**. Make a note of the email you entered which will be your username and the password to access the parent portal once finalised.

Step 2: School Verification

Once successfully registered and approved by the school, you will receive an email confirming your registration and a link to access the parent portal.

You can also login in to your parent portal via the following link:

<https://holsworthyhs.sentral.com.au/portal2/#!/login>

You will be prompted to enter your username (email address) and the password you created. Alternatively, you can visit the school's website and click on the Sentral Parent Portal tab to gain access.

Step 3: Registration Access Key

Once step 2 is successfully completed, you will receive an access key via correspondence.

To see information from the school and to link to a specific child, please enter the access key provided in your parent portal.

Please note that the access key is case sensitive so copy it into the box provided on screen, exactly as it appears in this letter.

I am confident that you will see the benefits of your registration immediately and be part of our journey in providing this facility to you.

As we progress this initiative, I am confident that the Parent Portal will become more and more significant in your day to day management of your child's enrolment at our school.

Should you experience difficulties please do not hesitate to contact the school for assistance, and any feedback will be gratefully received with a view to adding further functionality and improvement.

Kind Regards

Holsworthy High School